

Fishers.. the best of all worlds



Fairways Marine

To many yachtsmen the world over the Fairways Marine Range of Yachts are totally synonymous with Family Cruising. In every way the craft depicted in these pages meet the requirements of a widely varying but very discerning public – We think it is worth finding out why.

In today's developing world one of the disadvantages of increased efficiency is the monotony in the appearance of many production boats.

Looks are always a matter of personal taste of course, but the Fishers with their indefinable air of rightness and suitability of purpose always stand out in a crowd, qualities which elude so many other designers and builders.

How has this come about?

Fairways Marine was founded in 1969 by David Skellon, an airline Pilot and ex professional Yacht Skipper. Backed by his earlier deep sea sailing experience, and pilot's sense of technical perfection, the Company set out to create and promote a specifically designed cruising vessel of moulded G.R.P. construction, as others have developed hybrid ocean racers and sophisticated power boats.

Hence the conception of the Fisher.

By far the most important factor was the necessity to perfect a hull whose lines would achieve the ability to perform in all weather conditions under sail or power and especially both. The marine architect, Gordon Wyatt, was responsible for initiating the development of these lines from the Baltic Fisherman, a motor fishing vessel which enjoys a reputation amongst professional seamen for seaworthiness and the ability to work in extreme weather.

The characteristics of this traditional shape were refined to give an easy entry to soften pounding and help sailing ability; a generous beam to promote buoyancy; a 'Canoe' stern to minimize any broaching tendency; a 50% ballast ratio to create stiffness; and a long keel to ensure steady directional control which helps to balance the easily handled but powerful ketch rig.

Having resolved the hull shape, no less effort was given to the superstructure design. This incorporates wide side decks protected by high bulwarks, a safe working foredeck, deep self draining cockpit, and, of course, the characteristic trawler shaped wheelhouse with its built in warmth and comfort that enables the owner to sail throughout the year.

While outward appearances are of rugged dependability, the accommodation has been given the soft touch. Although every inch of available space has been utilised to the maximum, the combination of a selection of carefully chosen fabrics and the natural warmth of teak induce a below decks atmosphere of discreet elegance. Ease of living is further helped by a carefully designed, well equipped galley together with top quality marine fittings for cabin heating, lighting and ventilation.

So an idea has become a reality. By 1977 over 800 Fishers have been launched around the world through a network of distributors in 18 countries, and are being produced at the rate of between three and five boats per week. Fairways Marine has become a thriving business with full order books and employs over 250 skilled workers in three different factories. Managed by a team of people dedicated to efficiency, quality control and service to the customer, these objectives have never changed throughout the years of steady expansion, nor will they do so in the future.

Meanwhile Fisher development continues.

Although they are already very acceptable products, we are continuously striving for improvement and perfection. By attending to the very smallest details as well as researching, for example, new methods of variable pitch power transmission, and computer designed sails, we feel we really can provide the cruising yachtsman with

THE BEST OF ALL WORLDS.

The Fisher 25



Smallest of the Fisher class, the 25 offers a remarkable amount of accommodation for the cruising family. Generous cockpit and deck space is achieved by a transom type stern and raised foredeck. The main saloon and wheelhouse give the 'little ship' feel, and she is generally regarded as the biggest twenty-five-footer in the world! The robust hull, based on the classic Fisher line, affords excellent sailing qualities both in light airs or full gale conditions.

TECHNICAL DATA: L.O.A. 25'3" (7.69m), L.W.L. 21'0" (6.4m), Beam 9'4" (2.85m), Draft 3'9" (1.14m). Displacement 4.5 tons (4572 kgs). Sail Areas: Main 90 sq. ft. (8.36m²) Jib 100 sq. ft. (9.29m²) Mizzen 40 sq. ft. (3.72m²). Accommodation 5 berths. Engine Yanmar 2QM 20H developing 22 h.p. @ 2,800 r.p.m. Fuel: 40 Imp. gals. (182 lts.) Fresh water: 40 Imp. gals. (182 lts.). Standard Equipment: Compass, Echo sounder, Screen Wiper, 25lb. (11.4 kgs) C.Q.R. Anchor, 15 fathoms 1" chain, Bilge Pump, Warps and Fenders.

The Catfisher 28

The Catfisher 28 retains all the traditional characteristics, quality of finish and the aesthetic appeal of the Fisher mono-hull vessels, but is of course a Catamaran. It is indeed a truly amazing vessel in as much as the accommodation provides no less than two double cabins, one single cabin, a large comfortable deck saloon with inside steering and controls; a well equipped galley; and a large shower and toilet area. Externally there is an additional steering position availability in the cockpit, but the other enjoyable feature is the enormous amount of deck space for sunbathing, lounging, etc. afforded by the additional beam of a multi-hull.

The craft is available as a sloop rig for high performance windward sailing, alternatively a ketch rig for the more cruising conscious, and another essentially unique feature is the twin screw manoeuvrability provided by the hydraulic drive system from the single diesel engine propulsion unit. Manoeuvring under power therefore is as simple as a twin screw motor boat, the vessel can in fact revolve on its own axis.

The twin hull underbody shape features a substantial length of straight keel, enabling the craft to take the ground horizontally with complete protection for the twin propellers and rudders.

All in all a very versatile and useful vessel that has a well proven track record in very severe conditions, yet is capable of a very spritely and exciting sailing performance on an even keel with all of the advantages inherent in multi hull design. It is planned to introduce larger versions of this craft into the range at a later date.



TECHNICAL DATA: L.O.A. 28'0" (8.3m), L.W.L. 24' 5 1/2" (7.45m), Beam 13'1" (3.99m), Draft 3'5" (3860kgs). Sail Areas: Sloop Main 181 sq. ft. (16.8m²), Working Jib 166 sq. ft. (15.4m²). Ketch Main 147 sq. ft. (13.66m²), Mizzen 56 sq. ft. (5.20m²), Working Jib 156 sq. ft. (14.5m²). Accommodation: 7 Berths. Engine: 42 hp Marine diesel. Fuel: 30 gallons. Fresh Water: 70 gallons. Standard Equipment: Compass, Echo Sounder, Anchor, Anchor warp and chain, Two bilge pumps, warps and fenders.

The Fisher 30



The Fisher 30 is the forerunner and most popular version in our range. Over two hundred have been sold around the world, from Vancouver in the West to Tokyo Bay in the East.

After several years of continuous development, she is probably the optimum model for the average family yachtsman, who needs safety, seaworthiness, ease of handling, and a stimulating sailing performance.

TECHNICAL DATA: L.O.A. 30'0" (9.14m), L.W.L. 25'0" (7.62m), Beam 9'6" (2.90m), Draft 4'3" (1.29m). Displacement 6.5 tons (6604 kgs). Sail Areas: Main 150 sq. ft. (13.93m²) Jib 125 sq. ft. (11.61m²) Mizzen 55 sq. ft. (5.11m²). Accommodation: 6 berths. Engine: Volvo Penta MD3B Marine Diesel developing 36 h.p. @ 2,500 r.p.m. Fuel: 50 Imp. gals. (227 lts) Fresh water: 50 Imp. gals. (227 lts) Standard Equipment: Compass, Echo Sounder, Screen Wiper, Anchor Windlass, 35lb. (15.9 kgs). C.Q.R. Anchor, 30 fathoms $\frac{1}{8}$ " chain, Bilge Pump, Warps and Fenders.

The Northeaster 30

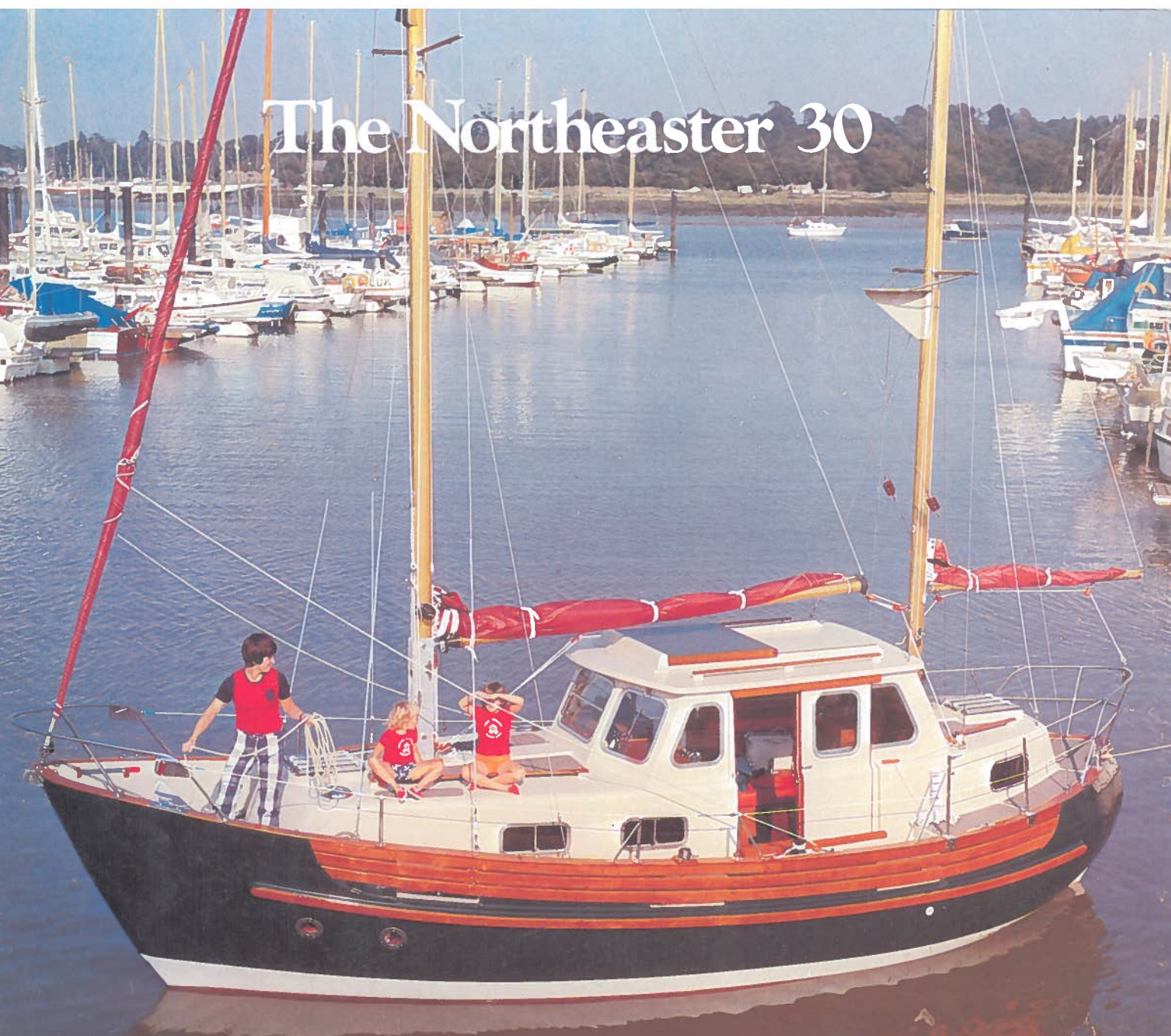

The Northeaster inherits all the basic design features of the Fisher class, and has capably proved her seagoing performance to be identical in every respect. There is one basic and additional feature – more accommodation.

The beam amidships has been increased which together with a two berth aft stateroom and wheelhouse deck saloon affords an air of spaciousness in the accommodation below-deck seldom found on vessels of this size.

TECHNICAL DATA: L.O.A. 30'0" (9.14m), L.W.L. 25'0" (7.62m), Beam 10'4" (3.14m), Draft 4'3" (1.29m). Displacement 6.5 tons (6604 kgs). Sail Areas: Main 150 sq. ft. (13.93m²) Jib 125 sq. ft. (11.61m²) Mizzen 55 sq. ft. (5.11m²). Accommodation: 6 berths. Engine: Volvo Penta MD3B Marine Diesel developing 36 h.p. @ 2,500 r.p.m. Fuel: 50 Imp. gals. (227 lts) Fresh water: 50 Imp. gals. (227 lts). Standard Equipment: Compass, Echo Sounder, Screen Wiper, Anchor Windlass, 35lb. (15.9 kgs). C.Q.R. Anchor, 30 fathoms $\frac{5}{16}$ " chain, Bilge Pump, Warps and Fenders.

The Fisher 37 (aft cockpit)

This must be the finest and most elegant yacht of its kind afloat today. Several of these vessels have successfully completed trans-ocean and extended cruises with 'Big Ship' security and sense of purpose. A powerful, close-winded sailing ship when required she is equally at home when punching against 40 knot plus wind conditions in open water. Just look at the displacement in comparison with the overall length and you will begin to realise the integrity of these craft. An inspection and trial sail afloat will not only confirm this, but also illustrate the highest standard of specification and supreme quality of finish.

TECHNICAL DATA: L.O.A. 37'0" (11.28m), L.W.L. 32'6" (9.91m), Beam 12'0" (3.66m), Draft 5'3" (1.60m), Displacement 14 tons (14,224 kgs), Sail Area: Main 312 sq. ft. (28.98 m²) Jib 290 sq. ft. (26.94 m²) Mizzen 109 sq. ft. (10.13 m²). Accommodation: 6 berths, Engine: Ford Sabre Marine Diesel developing 80 h.p. @ 2,400 r.p.m., Fuel: 100 Imp. gals (454 lts), Fresh water: 100 Imp. gals (454 lts) Standard Equipment: Refrigerator, Gas Water Heater, Gas Cabin Heater, Compass, Echo Sounder, Screen Wiper, 2-speed Anchor Windlatch, 45lb. (20.4 kgs) C.O.R. Anchor, 30 fathoms $\frac{1}{8}$ " chain, Bilo Pump, Warps and Fenders.



The Fisher 37 (aft cabin)

With an alteration to the cockpit we have provided a superb aft stateroom. This excellent addition to the 37 range includes another WC, shower, hand basin and twin berths, giving a self-contained suite for the owner or his guests. The remaining accommodation and specification is identical to the aft cockpit 37, having the same excellent passage making qualities, with the additional benefits of privacy and comfort the aft cabin provides. Access to the wheelhouse is still through the aft door via a small operating cockpit which allows a safe working area for sheet handling, a necessary but uncommon feature on fully enclosed yachts.

TECHNICAL DATA: L.O.A. 37'0" (11.28m), L.W.L. 32'6" (9.91m), Beam 12'0" (3.66m), Draft 5'3" (1.60m). Displacement 14 tons (14,224 kgs). Sail Areas: Main 312 sq. ft. (28.98 m²) Jib 290 sq. ft. (26.94 m²), Mizzen 109 sq. ft. (10.13 m²). Accommodation: 8 berths. Engine: Ford Sabre Marine Diesel developing 80 h.p. @ 2,400 r.p.m. Fuel: 100 Imp. gals. (454 lts). Fresh water: 100 Imp. gals. (454 lts). Standard Equipment: Refrigerator, Gas Water Heater, Gas Cabin Heater, Compass, Echo Sounder, Screen Wiper, 2-speed Anchor Windlass, 45lb. (20.4 kgs). C.Q.R. Anchor, 30 fathoms $\frac{1}{16}$ " chain, Bilge Pump, Warps and Fenders.



The Fisher 34

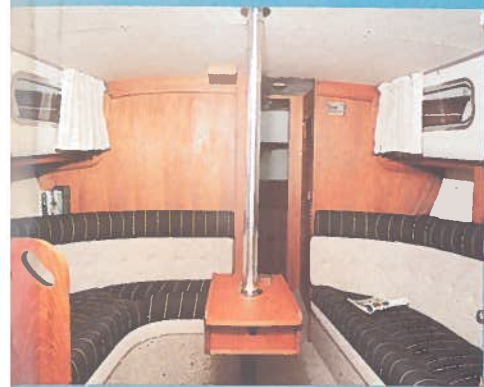

The 34 is the latest addition to the Fisher range, bridging the gap between the 30 and 37. Her design and layout embodies the best features of both the smaller and larger vessels but includes a unique double quarter berth stateroom giving two double private cabins as well as main saloon, deck saloon and cockpit.

TECHNICAL DATA: L.O.A. 34'4" (10.46m), L.W.L. 29'10" (9.1m), Beam 11'3" (3.42m), Draft 4'9" (1.44m), Displacement 10.50 tons (10,668 kgs). Sail Areas: Main 213 sq. ft. (19.79m²) No. 1 Jib 246 sq. ft. (22.85m²) Mizzen 66 sq. ft. (6.13m²) Accommodation: 7 berths. Engine: 60 h.p. Marine Diesel. Fuel: 80 Imp. gals. (364 lts). Fresh Water: 80 Imp. gals. (364 lts) Standard Equipment: Compass, Echo Sounder, Screen Wiper, Anchor Windlass 35lb. (15.9kgs), C.Q.R. Anchor, 30 fathoms $\frac{1}{8}$ " chain, Bilge Pump, Warps and Fenders, Gas Water Heater, Gas Cabin Heater.

The Fisher 46



Not only the largest but also the most sophisticated Fisher yet conceived. By virtue of the hull shape and displacement, the volume and therefore the accommodation is really quite enormous. Three double private staterooms; luxurious lower saloon; spacious deck saloon; two toilets and showers; inside and cockpit steering and control stations; unlimited deck space plus a detailed specification that is fully inclusive – **UNDOUBTEDLY THE BEST OF ALL WORLDS.**

TECHNICAL DATA: L.O.A. 45'8" (13.91m), L.W.L. 40' (12.19m), Beam 15' (4.57m), Draft 6'6" (1.98m). Displacement 25 tons (25,400 kgs). Sail Area: Main 400 sq. ft. (37.16m²) Jib 350 sq. ft. (32.51m²) Mizzen 140 sq. ft. (13m²). Accommodation: 8 berths. Engine: 120 h.p. Marine Diesel. Fuel: 250 Imp. gals. (1136 lts). Fresh Water: 250 Imp. gals. (1136 lts). Standard Equipment: Refrigerator, Gas Water Heater, Gas Cabin Heater, Compass, Log, Echo Sounder, Screen Wiper, 2-speed Anchor Windlass, 2 C.Q.R. Anchors 75lb. (34 kgs) and 45 lb. (20.4 kgs), 45 fathoms $\frac{1}{2}$ " chain, Electric and manual Bilge Pumps, Warps and Fenders, Fire extinguishers.

The Trawler 38

The Trawler 38 is the first of a new line of "little ships" from Fairways. It is completely unique in the fact that it is capable of doing 20 knots and 1000 miles nautical mile range (with optional engine and tankage). Very few other Trawler Yachts in the world can achieve that sort of performance, and none are capable of withstanding heavy weather and arduous conditions at full displacement speeds as comfortably as ours can. The reason: simple, many years of research and development by our design associates, experienced in the design and development of commercial fishing craft, have provided us with the prime ingredients for this comfortable, safe off-shore cruising power boat.

The accommodation is not only furnished to our usual exceptionally high standard of quality finish, but provides the owner with a luxuriously spacious double stateroom forward; double berth cabin (with slide out triple berth option for children); a very spacious toilet and wash basin area, with separate shower stall (two toilets and shower available as an option); a comfortable and well thought out main saloon with dining area, dinette with deck level galley, partially divided from the saloon by a breakfast bar counter.

The big ship style bridge houses the steering and engine controls, electronic navigational instrument facilities, chart stowage and chart table area with a comfortable seating facility for the helmsman and passenger.

Externally, the foredeck and sidedecks are well protected by a deep bulwark, and the afterdeck is large enough for owners and guests to sit or dine outside Mediterranean style. Up top the enormous sundeck over 12 feet square provides lavish sunbathing area for the warmer climates and an additional steering and engine control station can be supplied (as an option) installed in the dummy funnel. Like all Fairways craft, the Trawler retains that indefinable air of character and charm that other craft seldom achieve.



TECHNICAL DATA: L.O.A. 37'9" (11.50m), L.W.L. 32'2" (9.79m), Beam 13'9" (4.18m). Draft 3'9" (1.14m). Displacement (unladen) 10 tons (10160 kgs). Accommodation: 6 berths. Engines: Ford Sabre 120hp (optional 212hp turbocharged Ford Sabre diesels). Fuel: 325 gallons (1475ltrs) optional extra 325 gallons. Water: 200 gallons (908ltrs). Standard equipment includes refrigerator, gas water heater, gas cooker, compass, echo sounder, engine instrumentation, anchor windlass, manual and electric bilge pumps. Choice of forward cabin layouts.

A choice of four
interior colour schemes

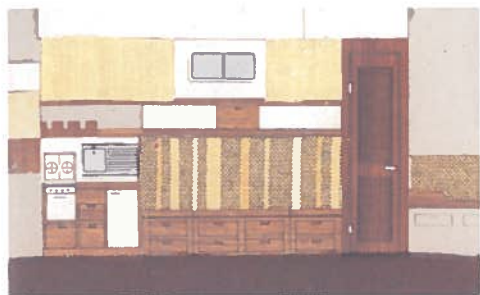

SCHEME 1



SCHEME 2

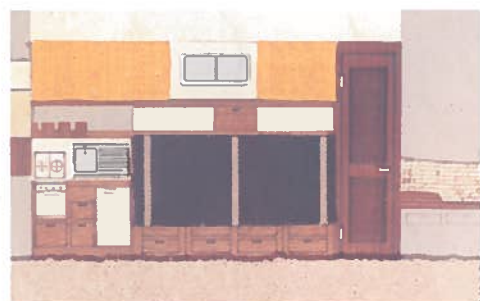

SCHEME 3



SCHEME 4

Some illustrations show optional
equipment. Performance,
specifications and prices are
accurate at date of printing but
may be superseded in the
interests of continuous
improvements of our yachts and
equipment

AUTHORIZED DEALER

Fishers.. the best of all worlds



FAIRWAYS MARINE
Skellon Yachts Ltd. Sales Division
Stone Pier Yard, Shore Road, Warsash, Nr. Southampton,
Telephone Locks Heath (048 95) 4104 Telex 477448.

Designed and Produced by Rodney Maton Associates Ltd. London & Southampton.